

## Get Started in 3 easy steps.

### 1 Remove Battery Tab

Two AA batteries are included inside the remote. Remove the red pull tab to activate.

#### Battery Replacement

- Press button and slide the battery door open.

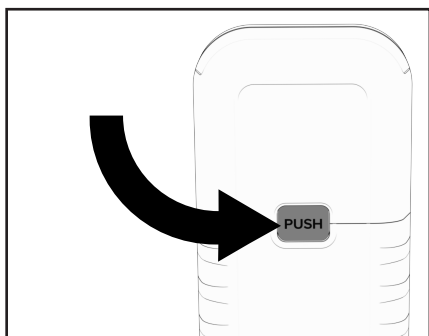

- Press red button to eject batteries.

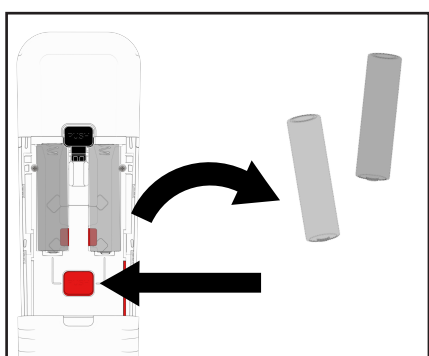

### 2 Pair to DISH

- On your DISH Box, open the button access door and press Sys Info or the Find Remote button.

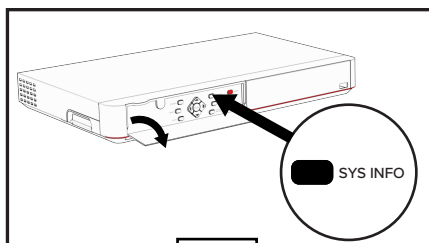

OR

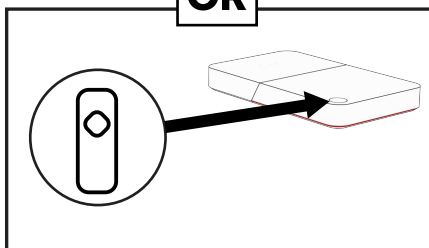

- Hold The Voice button on your remote and listen for 3 beeps. You're paired!

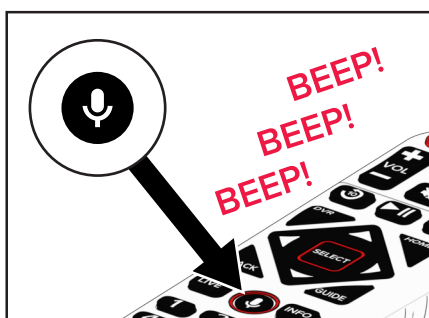

\* To unpair and reset process, press and hold Back and Home.

### 3 Pair to TV

To control Power and TV Volume with your remote.

- Press Home on the remote.



- On your TV, navigate to *Settings* or *Menu*. Select Remote Control.

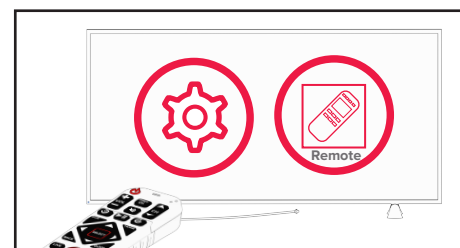

- Select TV then TV Pairing Wizard. Follow the onscreen prompts and you are all set!



## Explore Your Remote

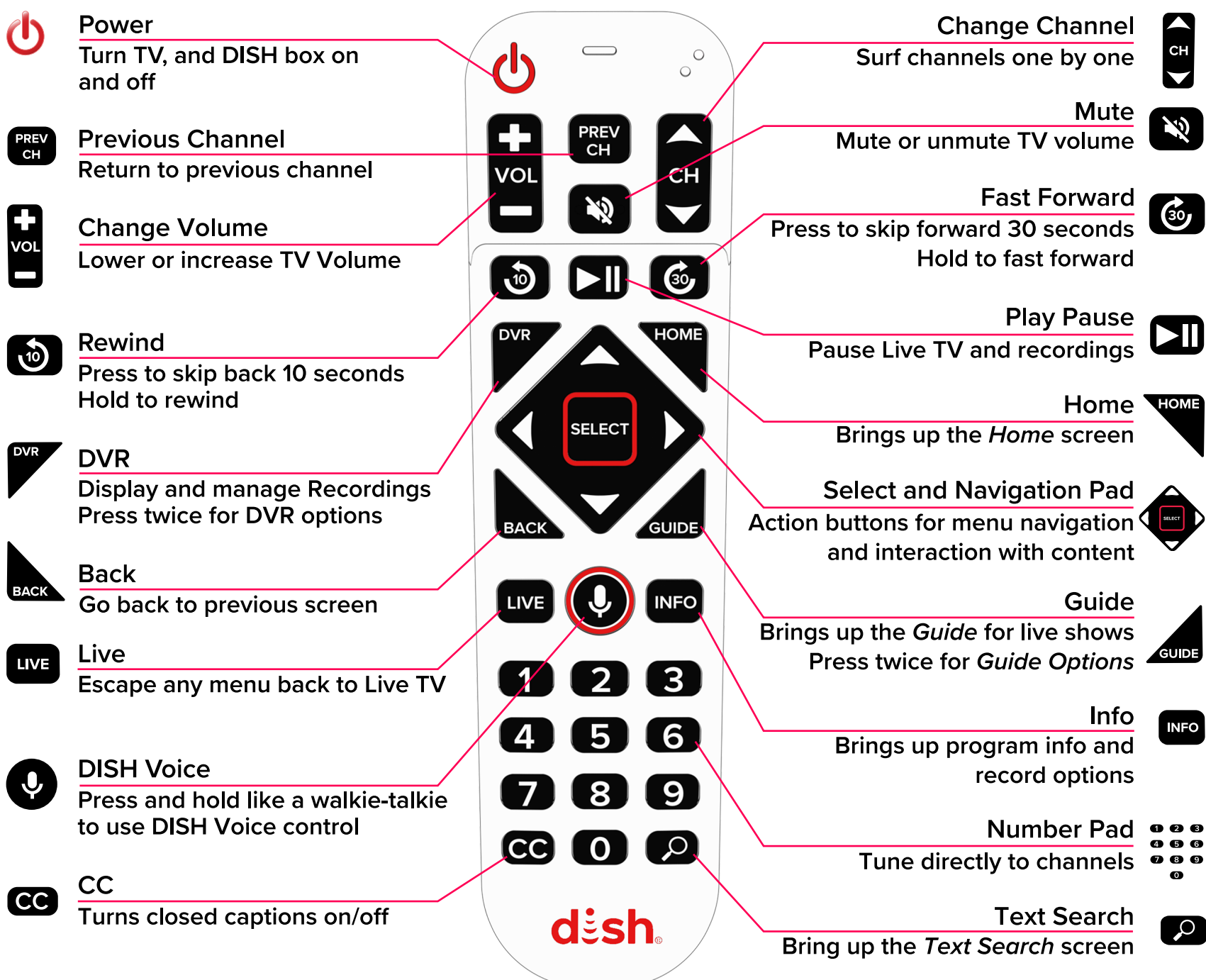

### Record from Live TV or Guide

Press Info to view Record Options and Record a program.

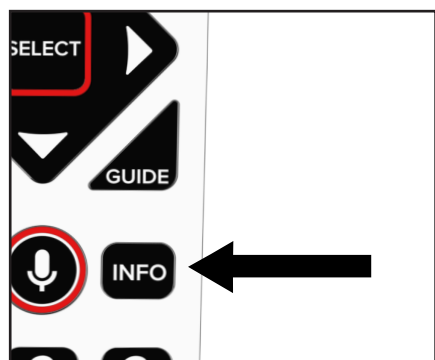

#### Lanyard Attachment

Optional: Secure a wrist strap to the base of the remote.

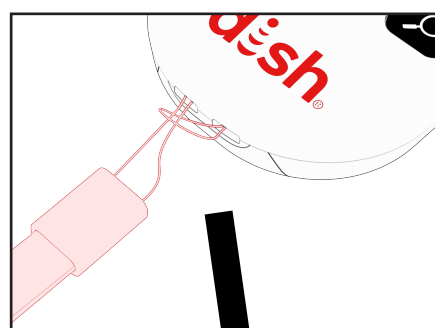

### Voice Command

With DISH Voice Commands, Press, Hold and Speak.

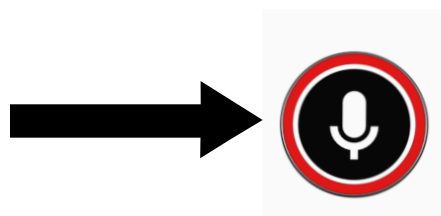

"Tune to ESPN"

"Open the Guide"

"Open Netflix"

"Record this"

"Rewind 30 seconds"

### Pair a Soundbar

- Press Home on the remote.

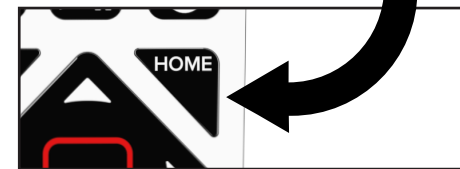

- On your TV, navigate to *Settings* or *Menu*. Select Remote Control then Auxiliary Device.

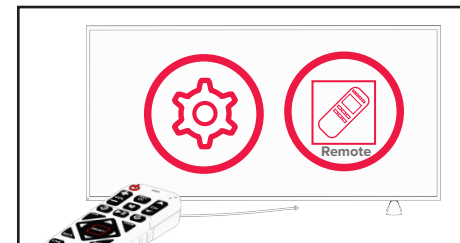

- Follow the prompts onscreen and you're set!

### More Resources

Need Help?  
1-800-333-3474



[support.dish.com/products](https://support.dish.com/products)

# Regulatory Information

This device complies with Part 15 of FCC Rules. Operation is subject to the following two conditions:

1. This device may not cause harmful interference,

and

2. This device must accept any interference received, including interference that may cause undesired operation.

This equipment has been tested and found to comply with the limits for a Class B digital device, pursuant to Part 15 of the FCC Rules. These limits are designed to provide protection against harmful interference in a residential installation. This equipment generates, uses, and can radiate radio frequency energy and, if not installed and used in accordance with the instructions, may cause harmful interference to radio communications. However, there is no guarantee that interference will not occur in a particular installation. If this equipment does cause harmful interference to radio or television reception, which can be determined by turning the equipment off and on, the user is encouraged to try to correct the interference by following one or more of the following measures:

- Reorient or relocate the receiving antenna.
- Increase the separation between the equipment and receiver.
- Connect the equipment into an outlet on a circuit different from that to which the receiver is connected.
- Consult the dealer or an experienced radio/TV technician for help.

Changes or modifications to this device may void your authority to operate this equipment.

## Safety Instructions

You must keep safety in mind while using this device. Keep these and any other instructions for future reference.

Observe Warnings: Carefully follow all warnings on the device and in the operating instructions.

## Case and Use

Cleaning: Do NOT use liquid, abrasive, solvent, or aerosol cleaners. Use a damp cloth for cleaning.

When Not in Use: Remove the batteries if this device is to be left unattended or unused for a long period of time.

Refer servicing to qualified personnel when a solid object or liquid has fallen onto or into the device.

Do NOT attempt to service this device. Refer all servicing to qualified personnel. Opening covers other than the battery cover will void the warranty.



Warranty, safety, regulatory, and legal information can be found at [mydish.com/support/remotes](http://mydish.com/support/remotes).

DN018924

